

**Drejeled**

Stål  
Konisk tryk rulleleje  
Smørbare

**Swivels**

Steel  
Tapered roller thrust bearing  
Greaseable

**Giratorios**

Acero  
Rodamiento a rodillos cónicos  
Depósito de grasa

Vare nr. Part no. Parte no.	SWL 5:1	A	A1	B	B1	B2	B3	C1	C2	D	E	F	G	Vægt Weight Peso
	Ton	mm	mm	mm	mm	mm	mm	mm	mm	mm	mm	mm	mm	kg
A810-TL19	10,0	195	160	115	13	11	18	18	43	14	37	20	33	8,7
A810-GF19	10,0	195	160	115	13	11	18	19	43	15	37	20	33	8,7
A812-TL23	12,0	200	162	135	17	14	22	23	49	17	40	20	38	9,7
A812-GF22	12,0	200	162	135	17	14	22	23	49	17	40	20	38	9,7
A817-26	17,0	250	208	150	21	16	25	27	57	20	53	29	47	17,3

TL = Parson  
GF = Gunnebo

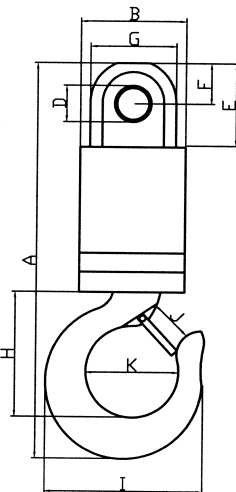

Vare nr. Part no. Parte no.	SWL 5:1	A	B	C	D	E	F	G	H	I	J	K	Vægt Weight Peso
	Ton	mm	mm	mm	mm	mm	mm	mm	mm	mm	mm	mm	kg
A 702-EK	2,0	218	54	20	20	45	22	45	80,0	102	29,5	41,2	2,0
A 705-EK	5,0	284	70	33	30	64	33	60	97,5	123	35,8	51,0	6,3
A 708-EK	8,0	377	85	42	34	73	39	75	150,0	192	56,5	76,0	10,5
A 712-EK	12,0	433	95	50	41	86	45	86	162,0	212	61,0	82,5	15,7

Mod tillæg kan alle drejeled leveres:  
'C' : Testede og med certifikat  
Ved bestilling, tilføj bogstav, f.eks.  
A817-CA26C

Against extra charge are all swivels  
available:  
'C' : Tested and with certificate  
On order add letter, e.g. A817-CA26C

Con cargo de precio los giratorios son  
disponibles:  
'C' : Probados y certificados  
En el caso de cotización, p.e. A817-CA26C